



Professional LED Street & Area Lighting







LSL-B Series: Street and area lighting available in 150W and 200W

The ENSA™ LSL-B Series comprises versatile LED lights with a variety of mounting and sensor options to deliver high performance street & area lighting. These luminaires offer impressive lighting with high energy efficiency in a robust slimline housing. LSL-B Series lights feature a wide range of mounting solutions to fit to a multitude of installation scenarios. Models also feature a built-in photo receptor for dusk/dawn switching.

LSL-B Series lights are ideal for illumination in street lighting applications, in area lighting for public spaces and for general purpose lighting in a variety of commercial and industrial building environments.

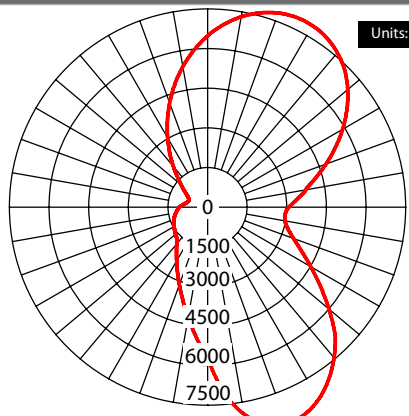
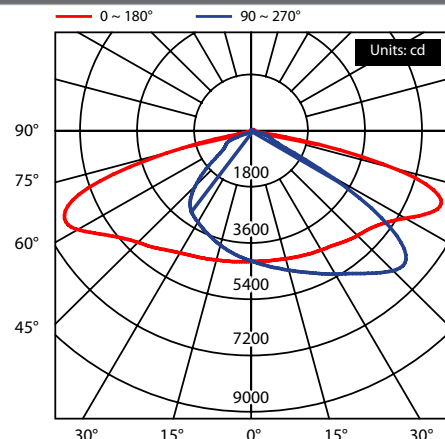
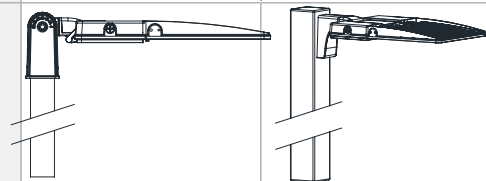
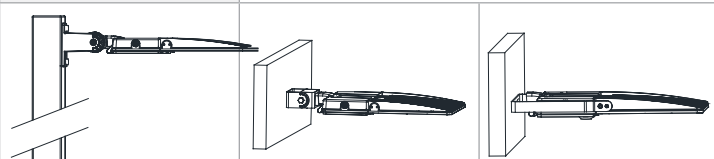
- High luminous efficacy up to 135lm/W
- Includes in-line surge protection for up to 20KV
- Batwing or square distribution for street & area lighting
- Robust IP66/IK08 weather & vandal resistant housing
- Long lifespan LED lighting: rated for up to 50,000 hours
- Photocell included; microwave motion sensor optional
- Rotate polycarb lens for easy light direction adjustment
- Versatile mounting with 5 adjustable brackets (*sold separately*)

Series Specifications

Model	LSL-B150-CP		LSL-B200-CP	
Product Image				
Series Name	LSL-B Series: LED Street Lights			
Optical				
Light Output	20,250lm		27,000lm	
Luminous Efficacy	135lm/W			
Colour Temperature	5000K cool white			
Colour Rendering Index	70			
Beam Angle	155° x 85°			
Light Decay	23% at 50,000 hours			
Rated Lifespan	50,000 hours			
Electrical				
Power Consumption	150W		200W	
Input Voltage	100 ~ 277VAC			
Power Factor	> 0.93			
Dimmable	1 ~ 10V / PWM			
General				
Ingress Protection	IP66			
Vandal Resistance	IK08			
Plug / Socket / Base	Unterminated			
Reflector / Diffuser	Clear polycarbonate Lens			
Operating Environment	-20° ~ 50°C			
Pole Diameter	Ø62.1mm (LSL-BKTS *sold separately)			
Dimensions	428 x 247 x 55mm		458 x 268 x 55mm	
Photometry				
Max Intensity Distribution (150W)				
Brackets				
				
	Slip Fitter Adjustable	Fixed Pole Mount	Adjustable Pole Mount	Trunnion Mount
	LSL-BKTS	LSL-BKTP	LSL-BKTA	LSL-BKTT
				Yoke Wall Mount
				LSL-BKTY

LSL-B Series: Photocell Documentation

The LSL-B-PC photocell is designed to automatically operate street lights, garden lights, passageway lighting and doorway lighting based on the surrounding natural light level. This photocell uses compliant twist-lock terminals for easy connection.

It features an electronic circuit with a photodiode sensor and an integrated surge arrester (MOV). Its fast response, combined with a built-in 3–20 second time delay, makes testing simple and convenient. In addition, the preset 3–20 second delay helps prevent false switching caused by momentary light sources such as headlights or lightning at night.



- Photocell included in LSL-B Series LED street lighting
- Dusk switching at 6lx, dawn switching at 50lx
- Built-in surge arrester (MOV; metal oxide varistor)
- Preset 3~20 second delay to prevent false activations

Wiring Diagram

Installation of this product and any connected fixture must be performed by a qualified, licensed electrician.

Care should be taken to avoid direct sunlight to mitigate the risk of overheating. Also avoid facing the photocell towards sources of artificial light to prevent inconsistent activation or false readings.

- Disconnect the power supply.
- Wire the receptacle according to the diagram shown on the right.
- Place the photocell onto the receptacle and twist it clockwise to lock it into position.
- Ensure that the photocell is facing south, as indicated on the top of the photocell.
- Adjust the receptacle orientation if necessary.

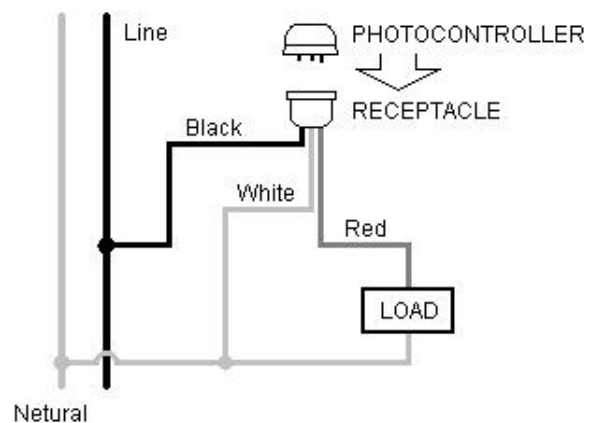

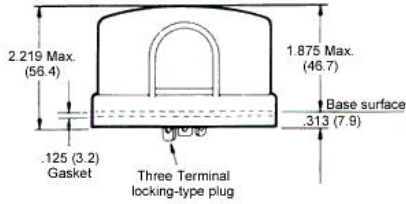
Model	LSL-B-PC	
Product Image		
Specifications		
Rated Voltage	220~240VAC	
Rated Frequency	50~60Hz	
Rated Loading	1000W Resistive/Tungsten loads 1800VA Inductive/LED loads	
Power Consumption	1.5VA	
Activation	Dusk switch / ON - 6lx Dawn switch / OFF - 50lx	
Operating Temp.	-20° ~ 50°C	
Relative Humidity	99%	
Dimensions	Ø84mm x 66mm	
Weight	0.1kg	

LSL-B Series: Accessory Selection

Slip Fitter (LSL-BKTS)

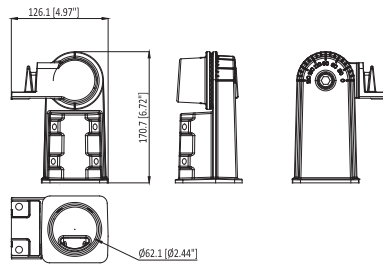
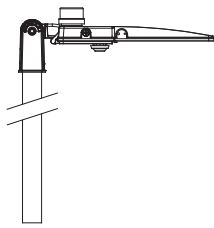

Pole Fixed (LSL-BKTP)

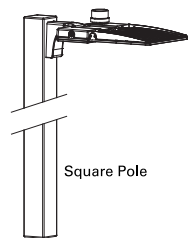

Square Pole

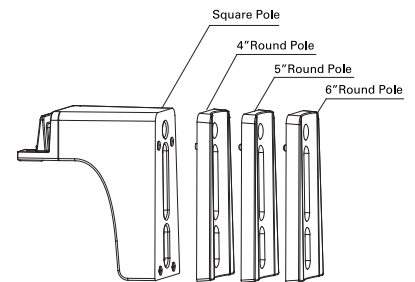
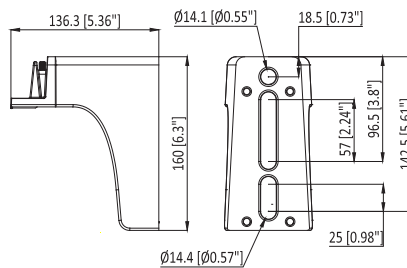

Pole Adjustable (LSL-BKTA)

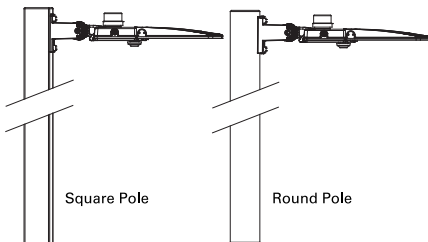

Square Pole

Round Pole

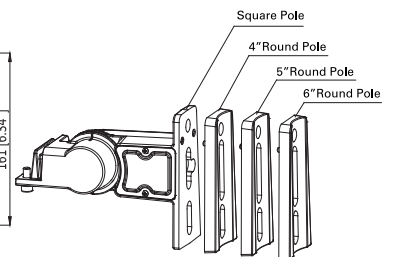
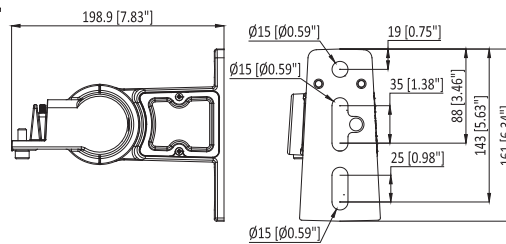

Trunnion Wall Adjustable (LSL-BKTT)

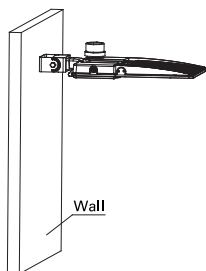

Wall

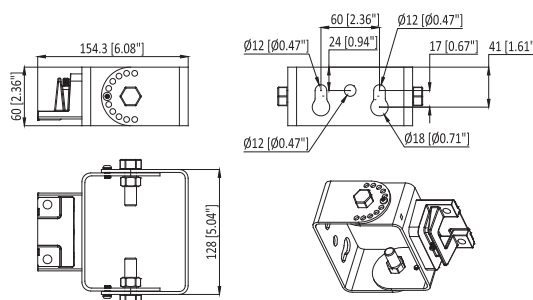

Yoke Wall Adjustable (LSL-BKTY)

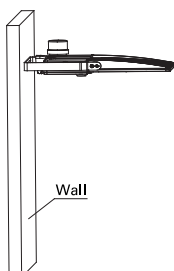

Wall

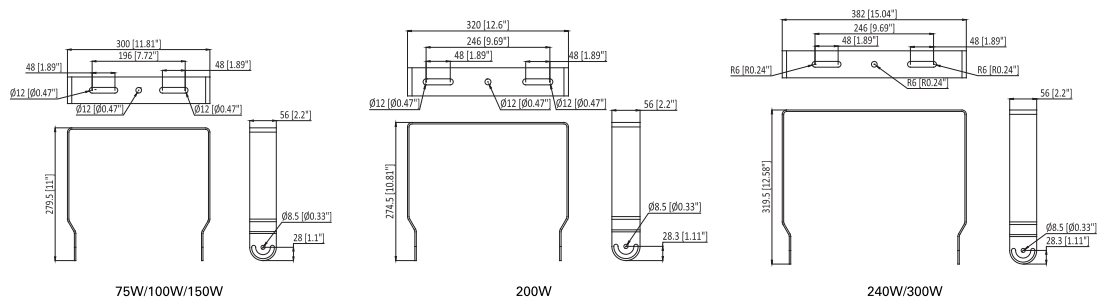

75W/100W/150W

200W

240W/300W