



You deserve to feel safe, secure & protected™



Heavy Duty Hard Wired Reed Switch

Model: RSW-M

Product Specifications

- Heavy duty magnetic contact switch
- Large magnet sensor gap, up to 50mm
- Normally open (N.O) reed switch output
- Closed loop when near magnet; open loop when away from magnet
- 10W maximum contact rating (up to 100V, 0.5A)
- 250mm sensor leads (22 AWG / Ø0.64mm)
- Robust casing of zinc alloy construction
- Surface mounted, screws included
- Dimensions 106 x 16 x 16mm

Product Dimensions

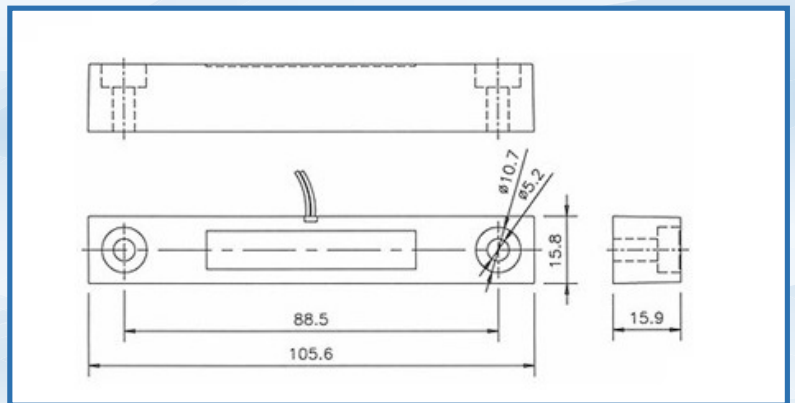

Your local Watchguard™ security professional: