



# Professional IP Intercoms

## Product Reference Guide



Stay connected with all that you love.™



## Stay connected with all that you love.<sup>TM</sup>

It is our mission to keep you in touch with the important things in life, especially the people, assets and places that support your livelihood.

VIP Vision helps keep you connected with all that you love through our range of professional intercom solutions. Designed for small to large residential and business applications, you can stay connected from anywhere.

Take control of visitors and boost security by having your premises always occupied with VIP Vision Residential Series intercom solutions. Answer unexpected door visitors with video/audio chat, ensure deliveries are made securely, and deter criminals checking to see if anybody is home. You can also enable greater access freedom to those you trust with remote unlocking via smartphone or tablet.

VIP Vision also offers excellent versatility in large residential spaces with Multi-tenant Series IP intercoms. The range scales to provide effective multi-dwelling intercom/access solutions for small duplex to large apartment applications. VIP Vision IP intercom systems can also leverage existing network infrastructure, keeping installation & maintenance costs low.

To improve access and boost security choose VIP Vision professional IP intercom solutions and stay connected to all that you love.



# Contents | VIP Vision™ Intercom Product Solution Guide

## 4 Residential IP Intercom Series with WiFi

IP based system also featuring WiFi wireless connectivity making it one of the easiest systems to install.



## 6 2-Wire IP Intercom Series

Upgrade existing 2-wire systems to modern IP intercoms, all using pre-existing 2-wire cabling infrastructure.

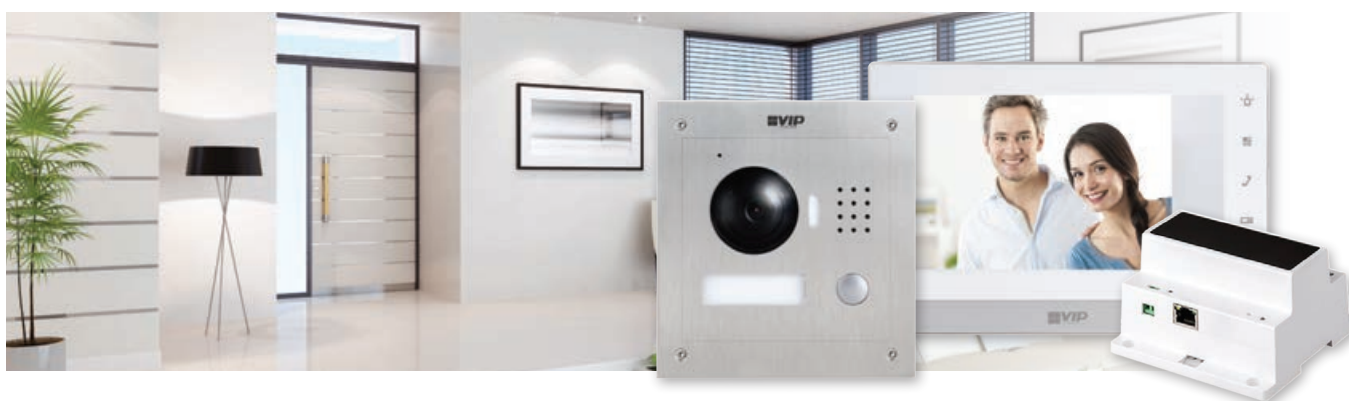

## 10 Multi-tenant IP Intercom Series

Modular and scalable IP intercom systems with a variety access control options designed for large residential applications.



## 14 Model Quick Reference

Quick guide for selecting your VIP Vision IP intercom system.



# Elegant access solutions.

## Residential Series: WiFi-capable IP intercom systems for home & business

The VIP Vision Residential IP Video Intercom features wireless connectivity making it one of the easiest systems to install. Experience a multitude of modern intercom features, all using your existing network or WiFi infrastructure.

- 1.0 megapixel, low-light door station camera
- Door stations calls all programmed indoor monitors
- Connect door station/monitor via WiFi or Ethernet
- Intuitive single-button interface for ease of use
- Interface with most electronic door strikes & sensors
- Elegant black or white gloss intercom monitors
- Slim profile 7" touchscreen indoor intercom monitor
- Receive visitor notifications, leave audio & video messages, remote view, remote unlock and 2-way talk via iOS & Android devices



**7" Slimline Touchscreen Monitor**





**Connect via WiFi or Cable Network**



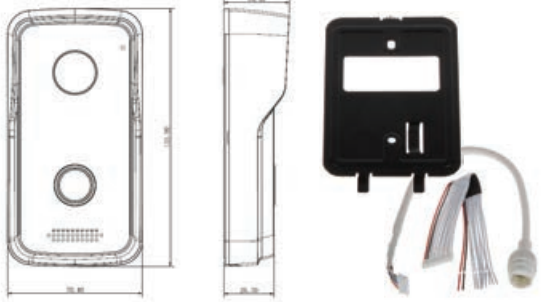
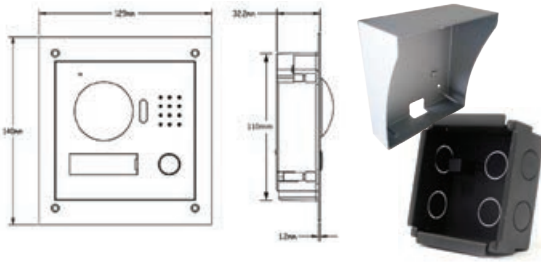

**Two-way talk & Remote Unlock**

## Residential Door Stations | Series Specifications

Model		INTIPRDSDB	INTIPRDSVW
General	Product Image		
	Main Processor	Embedded Microprocessor	
	Camera System	1.4" 1.0 Megapixel CMOS with 2.2mm lens (Diagonal FoV: 125°)	1.3" 1.3 Megapixel CMOS with 2.8mm lens (Diagonal FoV: 120°)
	Low-Light Application	Backlit interface / Day/Night ICR	N/A
	Card Support	Yes, Built-in NFC Card Reader	N/A
	Tamper Detection	Yes	
	Input / Output	2 x relays for door control / 2 x channel alarm interface / 1 x RS485	
	Audio / 2-Way Talk	Omni-directional Microphone & Embedded Loudspeaker for 2-way talk	
	Internal MicroSD Slot	Yes, up to 64GB	N/A
	Ethernet / Network	10M/100Mbps Self-adaptive / TCP/IP protocol	
Environmental	Vandal Resistant	N/A	IK07
	Ingress Protection	IP65 (door station front only)	IP54
	Construction	Matte Plastic	Stainless Steel
	Installation Kit	Includes surface mount bracket & Ethernet cable adapter	Includes surface mount rain shield/bracket; flush mount optional
	Power Input / Use	12VDC, PoE (802.3af) / Standby < 1W / Operation < 10W	12VDC, Standby < 1W / Operation < 10W
Diagrams	Weight / Dimensions	0.40kg / 135 x 70 x 34mm	0.80kg / 130 x 140 x 32mm
	Installation		 INTIPRDSVW-FMA: Flush mount box (optional)

## Standard Intercom Monitors | Series Specifications

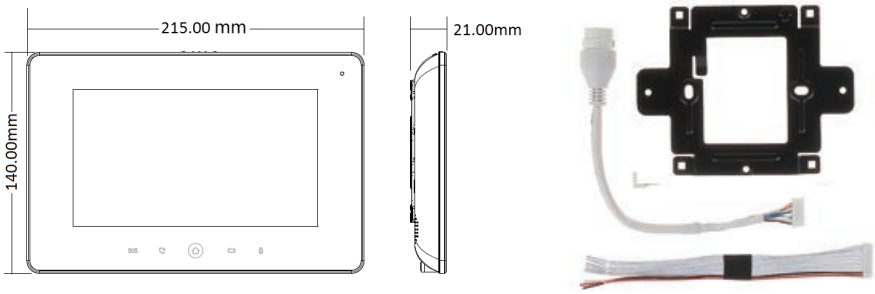
Model		INTIPMONDB (Black) / INTIPMONDW (White)	
Intercom Monitor	Product Image		
	Main Processor	Embedded Microprocessor	
	Audio / 2-Way Talk	Omni-directional Microphone & Embedded Loudspeaker for 2-way talk	
	Display Size	7" Colour TFT LCD (1024 x 600 pixels) with Capacitive Touchscreen & Soft Keys	
	Alarm Support	6 Input / 1 Output	
	Internal Capacity	MicroSD port max 32GB	
	Ethernet / Network	10M/100Mbps Self-adaptive / TCP/IP protocol	
General	Installation	Included surface wall mounting kit & Ethernet cable adapter	
	Operating Temperature	-10 ~ +55°C / 10 ~ 90%RH (max.)	
	Power Input / Use	12VDC, PoE (802.3af) / Standby < 1W / Operation < 7W	
	Weight / Dimensions	0.80kg / 215 x 140 x 21mm	
Product Diagram			





# Perfect intercom upgrades.

## 2-Wire Series: Upgrade intercom systems over existing 2-wire infrastructure

The 2-wire Residential IP Video Intercom is the perfect upgrade solution to your old intercom or door bell system. Upgrade and experience a multitude of modern intercom features, all using your existing two-wire infrastructure.

- 1.3 megapixel, low-light door station camera
- Door stations calls all programmed indoor monitors
- Connects to your network using Network Controller
- Interfaces with electronic door strikes and sensors
- Intuitive single-button interface for ease of use
- Surface mount monitor; white gloss & aluminium
- Slim profile 7" touchscreen indoor intercom monitor
- Receive visitor notifications, leave audio & video messages, remote view, remote unlock and 2-way talk via iOS & Android devices



**Upgrade Existing 2-Wire Systems**





**Add 2-Wire Systems to Network**

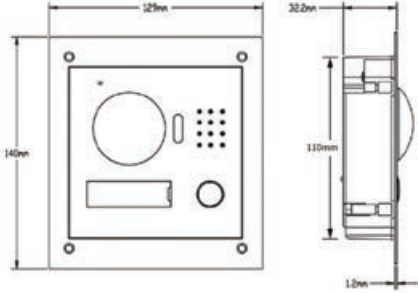

**Two-way talk & Remote Unlock**

## Series Specifications

Model		INTIPRDSVW2W
General	Product Image	
	Main Processor	Embedded Microprocessor
	Backlit Interface	N/A
	Card Support	N/A
	Tamper Detection	Yes
Camera	Camera System	1.3" 1.3 Megapixel CMOS with 2.8mm lens (Diag. FoV: 120°)
	Audio Input	Omni-directional Microphone
	Audio Output	Embedded Loudspeaker
	Bidirectional Talk	Support
	Ethernet	10M/100Mbps Self-adaptive
Environmental	Network Protocol	TCP/IP
	Vandal Resistant	IK07
	Ingress Protection	IP54
	Installation	Includes surface mount rain shield/bracket
	Power Input	24VDC
Accessories	Power Consumption	Standby < 1W / Operation < 7W
	Weight / Dimensions	0.80kg / 130 x 140 x 32mm
	Product Diagram	
	Compatible Brackets	
		INTIPRDSVW-FMA: Flush mount box (optional)

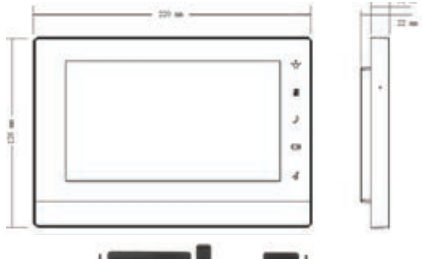
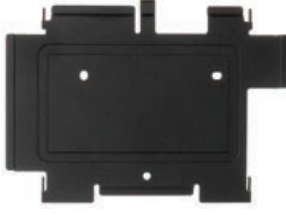
Model		INTIPMONFB2W
Monitor	Product Image	
	Main Processor	Embedded Microprocessor
	Video Compression	H.264
	Audio Input	Omni-directional Microphone
	Audio Output	Embedded Loudspeaker
Monitor	Bidirectional Talk	Support
	Display Size	7" Colour TFT LCD
	Display Resolution	SVGA (800 x 480)
	Alarm Support	Yes; 6 Input channels / 1 output channel / 1 x RS485
	Operational Input	Resistive Touchscreen / On-unit Soft Keys
Environmental	Internal Capacity	4GB MicroSD Card (removable)
	Ethernet	10M/100Mbps adaptive
	Network Protocol	TCP/IP
	Operating Temperature	-10 ~ +60°C / 10 ~ 90%RH (max.)
	Installation	Surface wall mounting bracket & kit
Environmental	Power Input	24VDC
	Power Consumption	Standby < 1.5W / Operation < 7W
	Weight / Dimensions	0.80kg / 200 x 136 x 22mm
	Product Diagram	
		

## Additional Accessories



### 2-Wire Residential Intercom Network Controller

Model: INTIPNC2W

Connect your 2-wire system to the Internet using the 2-wire Intercom Network Controller. Then link the app to your intercom to answer visitors, take snapshots/recording and even unlock doors, all from your smartphone or tablet.

- Facilitates network/power connectivity to 4 x 2-wire intercom devices
- Connect intercom system to the Internet for use with remote view app
- Provides 24VDC power with a maximum power load of 30W
- Includes surface mount and DIN-rail mounting options

## Residential Series Typical Installation | System Map

Easily install the VIP Vision IP Intercom System using the existing IP or WiFi network. The system can integrate IP cameras, up to 5 indoor intercom monitors and up to 20 door stations.

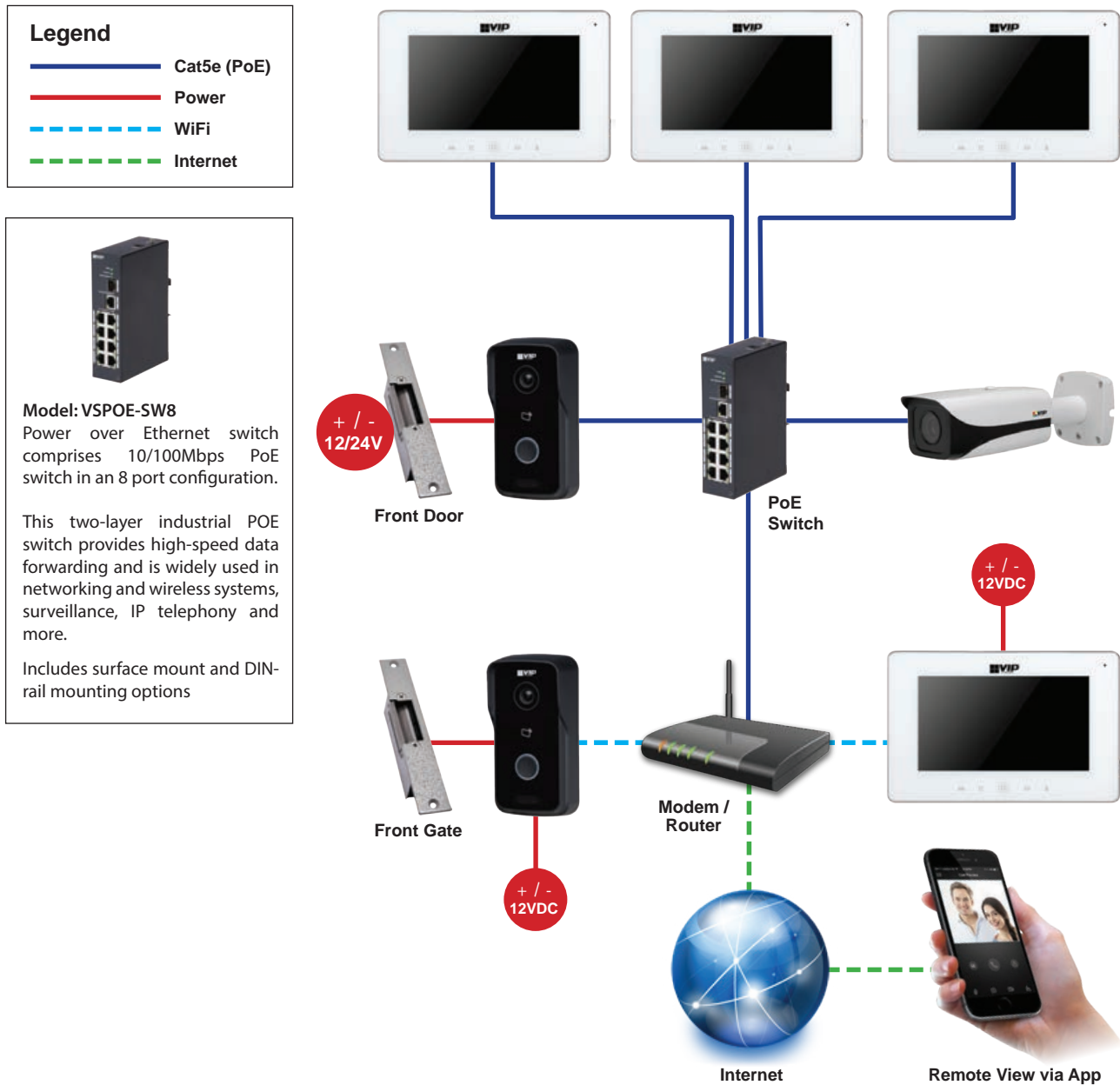

## Residential Series Door Station Only | System Map

The intuitive door station can also be used without an intercom monitor by using a smart phone or tablet instead via the app.

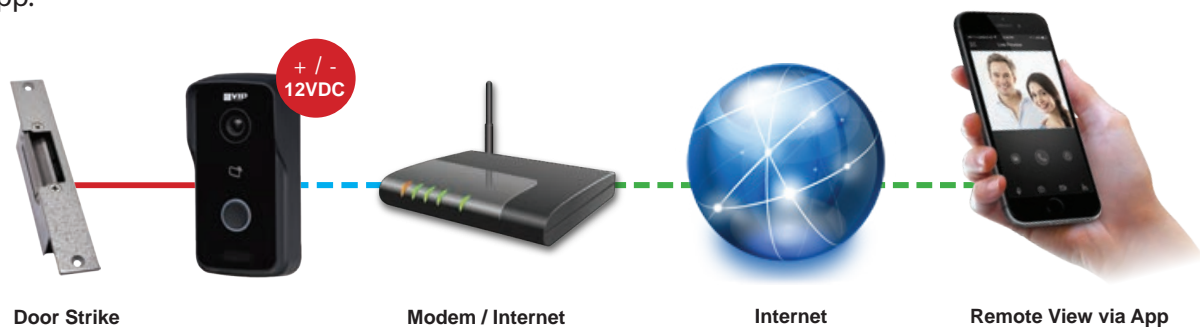



## 2-Wire Series Installation with Remote Connectivity | System Map

The VIP Vision 2-Wire Intercom System can quickly upgrade an existing 2-wire door bell or intercom unit. Add up to four 2-wire devices and remote connectivity with your smartphone by using the network controller.

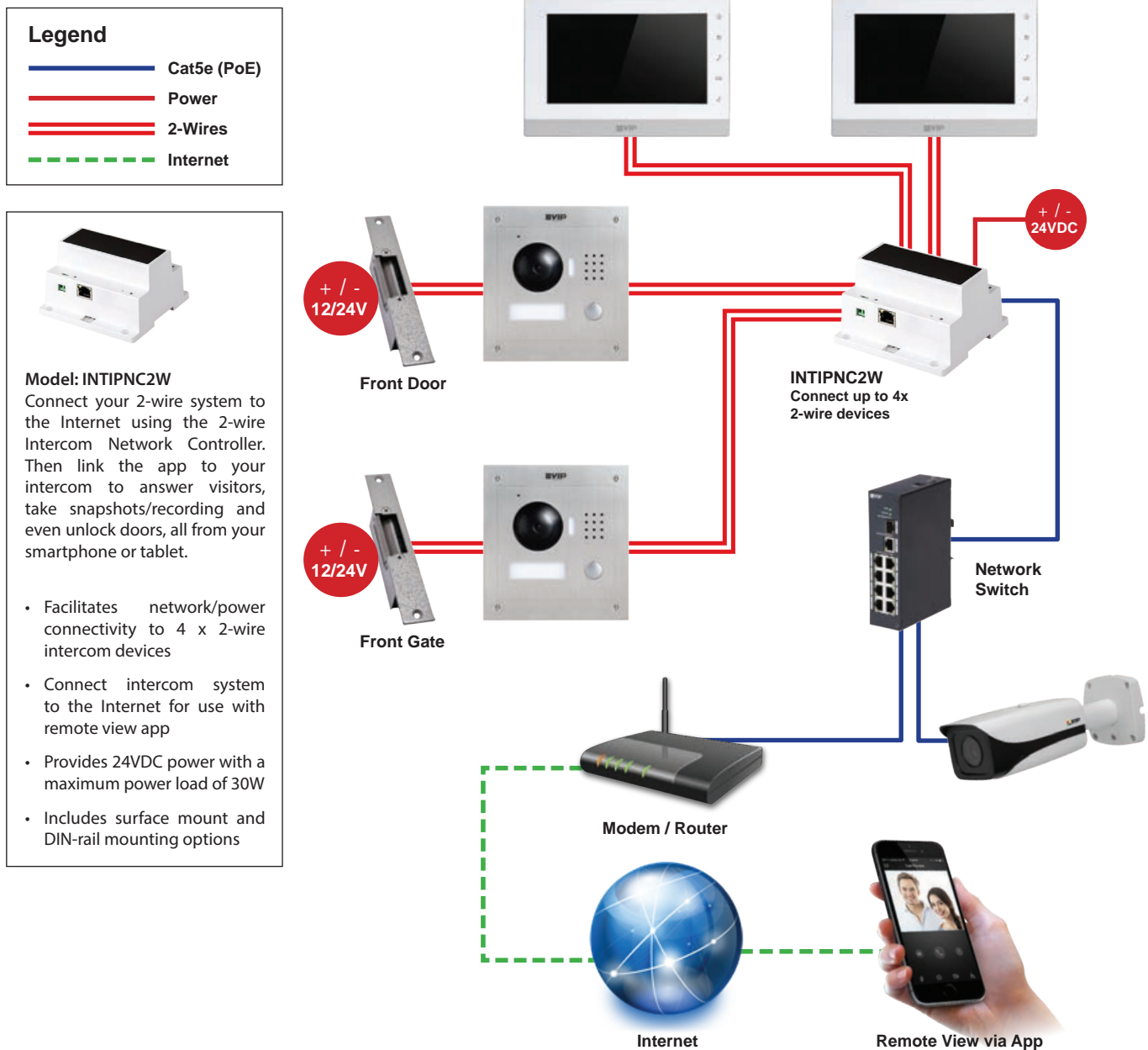

## 2-Wire Series without Remote Connectivity | System Map

The 2-Wire intercom system can be fitted without network connectivity. However, this system will not be able to be accessed remotely.





# Scalable intercom solutions.

## Multi-tenant Series: Modular design for large IP intercom installations

Scale up your intercom installations with the Multi-tenant Series from VIP Vision with support for up to 100 monitors and 20 door stations. Add layers of access control with fingerprint, IC card, 3-button and keypad modular units.

- 5 different modules to customise access control
- Camera module supplies power to other modules
- Door stations calls a single targeted indoor monitor
- Integrates with standard indoor monitors
- Interface most electronic door strikes & sensors
- 1.3 megapixel low-light door station camera module
- Fingerprint, keypad, button & card add-on modules
- 2 and 3 module surface or flush mount enclosures, and large 9 module flush mount enclosure
- Ideal for small apartments & multi-tenant buildings



Add up to 100 Indoor Monitors



Variety of Access Options



Flexible Modular Mount Options

## Multi-tenant Series | Series Features



## Call select rooms.

Customise modules to call individual dwellings.

Program button and keypad modules to call select indoor intercom monitors. This is perfect for large residential dwellings with multiple intercom monitors, including:

- Apartment blocks with single access door
- Hotel and motel complexes with multiple rooms
- Large villas with split accommodation/dwellings
- Duplexes and paired residential dwellings

## Add functionality.

With up to 4 different modular intercom units.

The camera module acts as the master unit, connecting power and data to the other intercom modules. There are four different types of modules for access and room calling:

- **Keypad:** Calls monitors & unlocks door with code
- **Reader:** Add RFID cards to unlock communal door
- **Fingerprint:** Biometric authentication for unlock
- **Button:** Additional 3 buttons for monitor calling



## Scalable systems.



Expand up to 20 door stations and 100 monitors.

The Multi-tenant Series is perfect for large scale systems with support for up to 100 intercom monitors and multiple door unlocking. It also features a range of mounting options to ensure a professional installation.

- 2 and 3 module flush mount and surface mount options; Large 9 module flush mount option
- Additional door unlock expansion via RS485
- Power over Ethernet intercom monitors for ease of large scale installation.

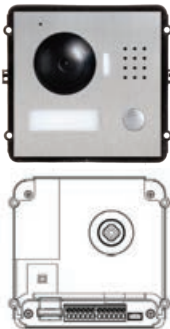
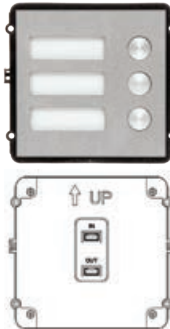
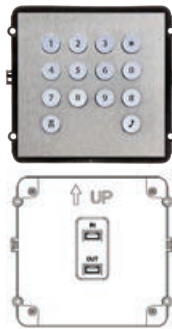
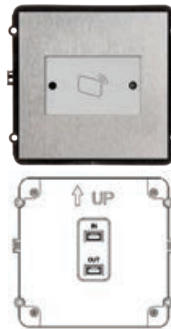

## Intercom Modules | Series Specifications

Model		INTIPVDS C	INTIPVDS B	INTIPVDS K	INTIPVDS R	INTIPVDS F
General	Product Image					
	Image Sensor	1/3" 1.3MP CMOS	-	-	-	-
	Lens	2.8mm	-	-	-	-
	Angle of View	120° (diagonal)	-	-	-	-
	Reader	-	-	-	RFID Card	Fingerprint
	Proximity Sensor	-	-	-	1m	-
	Keypad	Mechanical Button	Mechanical Button	Mechanical Button	-	-
	Door Control	1 Relay Out 1 RS485 1 Feedback 1 Exit Button	-	-	-	-
	Tamper Switch	1	-	-	-	-
Ethernet	10M/100Mbps	-	-	-	-	
Environmental	Protection	IP54 weather rated / IK07 vandal rated				
	Installation	Surface or flush mount options shown below				
	Material	Stainless Steel				
	Working Temperature	-40°C ~ +60°C				
Power	12/24VDC, <10W	Powered by INTIPVDS C				

## Intercom Accessories | Series Specifications

Model		INTIPVDSB2 + INTIPVDSFP2	INTIPVDSB3 + INTIPVDSFP3	INTIPVDSFB2 + INTIPVDSFP2	INTIPVDSFB3 + INTIPVDSFP3	INTIPVDSFPFB9
General	Product Image					
	Mount Type	Surface	Surface	Flush	Flush	Flush
	Dimensions	262 x 150mm	377 x 150mm	256 x 144mm	368 x 144mm	437 x 369mm

## Additional Accessories



### Intercom Relay Module

Model: INTIPDM

The intercom relay module (INTIPDM) allows the expansion of door station features to control another door or gate. Control any N.O/N.C device via RS485.

Compatible with Residential Series, 2-Wire Series and Multi-tenant Series door stations.

## Multi-tenant Series Installation | System Map

Customise your intercom installation for the number of users and level of access control you require. Create tailored IP intercom solutions using modular units, with up to 20 x door stations and 100 x intercom monitors.

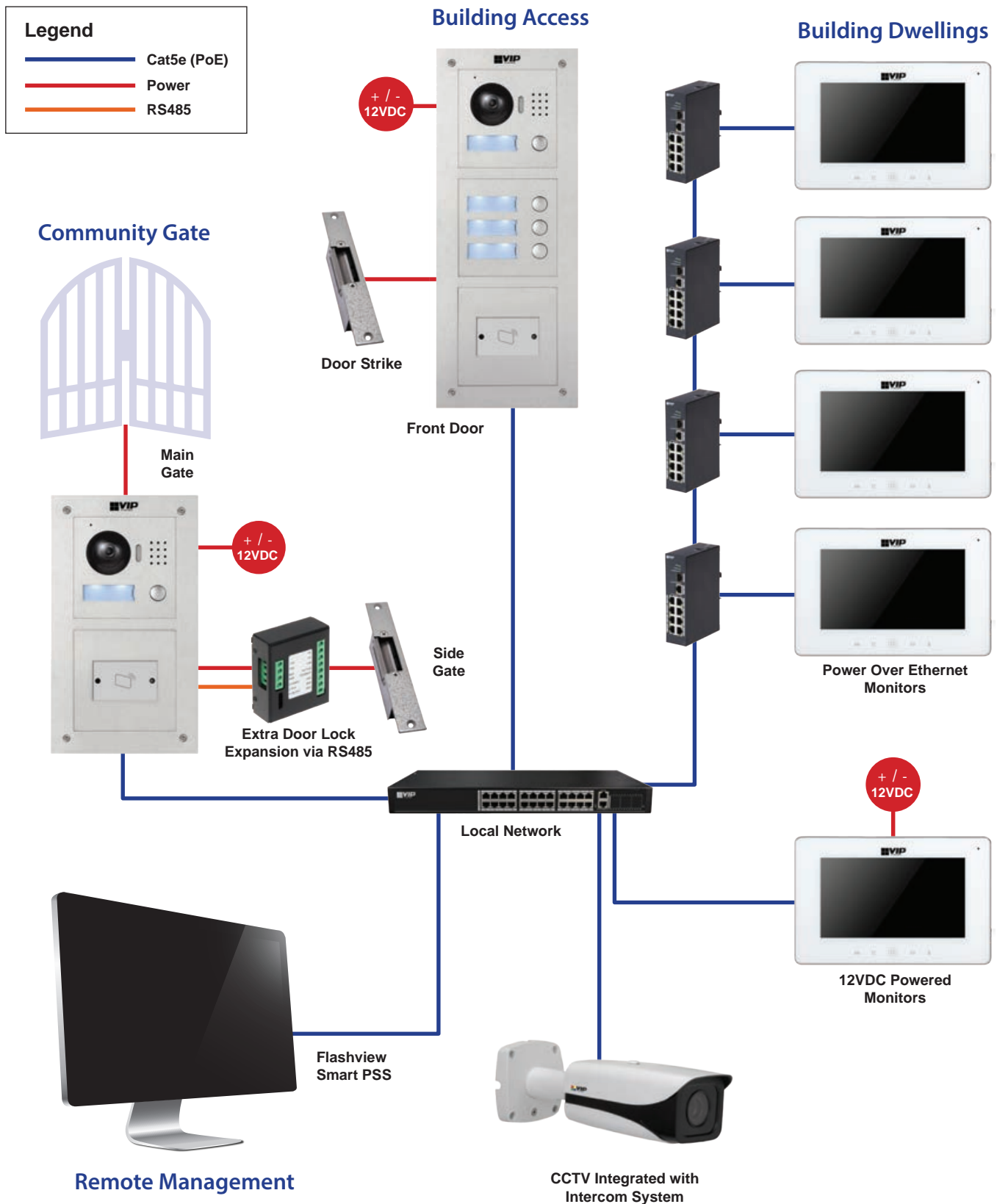

## Model Quick Reference

Quick guide for selecting your VIP Vision IP intercom system. Included accessories are not shown - please check product series pages for each series full range of accessories and components.



### Residential Series

Type	Model
Door Stations	
	Vandal Door Station: INTIPRDSVW WiFi / PoE Door Station: INTIPRDSDB
Monitors	
	WiFi / PoE Capable Monitors: INTIPMONDB (black) / INTIPMONDW (white)
Accessories	
	Flush Mount Box: INTIPRDSVW-FMA Door Expander via RS485 Module: INTIPDM

### 2-Wire Series

Type	Model
Door Stations	
	2-Wire Vandal Door Station: INTIPRDSVW2W
Monitors	
	2-Wire Monitor: INTIPMONFB2W
Accessories	
	Flush Mount Box: INTIPRDSVW-FMA Door Expander via RS485 Module: INTIPDM

### Multi-tenant Series

Type	Model
Door Stations	
	Master Unit: INTIPVDSC (camera) / Add-on Units: INTIPVDSB (button) / INTIPVDSF (fingerprint) / INTIPVDSR (reader) / INTIPVDSK (keypad)
Monitors	
	WiFi / PoE Capable Monitors: INTIPMONDB (black) / INTIPMONDW (white)
Accessories	
	Flush Mount: INTIPVDSFB2 / INTIPVDSFB3, Surface Mount: INTIPVDSSB2 / INTIPVDSSB3, Front Plate: INTIPVDSFP2 / INTIPVDSFP3 Combined Front Plate & Flush Mount Kit: INTIPVDSFPFB9 Door Expansion via RS485 Module: INTIPDM





## **Stay connected with all that you love.™**

Achieve more than security with VIP Vision and the Flashview™ smartphone app. Receive instant surveillance alerts, live view your cameras, playback footage, take snapshots and even remotely unlock your intercom-connected door lock. Do this and more from anywhere with your VIP Vision IP system and Flashview.

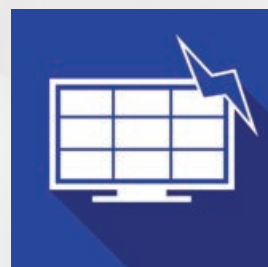



Stay connected with all that you love.<sup>TM</sup>

Contact your local VIP Vision network intercom professional:



[www.vip-vision.com](http://www.vip-vision.com)