



# Elegant access solutions.

## Residential Series: WiFi-capable IP intercom systems for home & business

The Residential IP Video Intercom series features wireless connectivity, making installation a simple task. Experience modern intercom features such as video & two-way talk, all using your existing network or WiFi infrastructure.

- Door station cameras ranging up to 2.0 megapixel
- Door stations call all connected indoor monitors
- Connect door station/monitor via WiFi or Ethernet
- Intuitive interface, for ease-of-use for any visitors
- Interface with most electronic door strikes & sensors
- Elegant black or white gloss intercom monitors
- Slim profile 7" touchscreen indoor intercom monitor
- Receive visitor notifications, leave audio & video messages, remote view, remote unlock and 2-way talk via iOS & Android devices



**7" Slimline Touchscreen Monitor**



**Connect via WiFi or Network Cable**



**Two-way talk & Remote Unlock**

## Multi-tenant Series | Series Features



## Suit any residence.

Wide range of door stations to suit your exact needs.

Each door station in the Residential Series has different designs, specs and functions, giving you the freedom to choose the perfect door station for the job:

- **INTIPRDSVW:** 1.3MP stainless steel door station (IK07)
- **INTIPRDSDB:** 1.0MP WiFi matte plastic door station with NFC card reader
- **INTIPDDS:** 2.0MP aluminium door station with NFC card reader & two buttons (IK08)

## WiFi connectivity.

Cable-free connection between monitor and station.

Enjoy an easy installation job with the WiFi-ready Residential Series. Simply connect the indoor monitor to your network and access a myriad of features, including:

- **Two-way talk:** Have a conversation with the visitor
- **Snapshot/Recording:** Record or take a screenshot of the visitor at the door, stored via microSD card

*\*WiFi functionality only available for INTIPRDSDB*



## Mobile access.

Gain entry and view visitors via smartphone app.

Gain access to your home and answer the door from anywhere with the free smartphone app. View and converse with visitors as if you were right at home.

- Integrate your phone to your system as a way of access
- Ask deliverymen to drop off packages
- Check for potential intruders with remote view

## Residential Door Stations | Series Specifications

Model	INTIPRDSVW	INTIPRDSDB	INTIPDDS2
Product Image			
Main Processor	Embedded Microprocessor		
Camera System	1/1.3" 1.3 Megapixel CMOS with 2.8mm lens Angle adjustable (Diagonal FoV: 120°)	1/1.4" 1.0 Megapixel CMOS with 2.2mm lens (Diagonal FoV: 125°)	1/2.8" 2.0 Megapixel CMOS with 1.9mm lens (Horizontal FoV: 140°)
Low-Light Application	N/A	Backlit interface / Day/Night ICR	Day/Night ICR
Card Support	N/A	Yes, Built-in NFC Card Reader	Yes, Built-in NFC Card Reader
Tamper Detection	Yes		
Input / Output	2 x relays for door control / 2 x channel alarm interface / 1 x RS485	2 x relays for door control / 2 x channel alarm interface / 1 x RS485	1 x relay for door control / 2 x channel alarm interface / 1 x RS485
Audio / 2-Way Talk	Omni-directional Microphone & Embedded Loudspeaker for 2-way talk		
Internal MicroSD Slot	N/A	Yes, up to 64GB	N/A
Ethernet / Network	10M/100Mbps Self-adaptive / TCP/IP protocol		
Vandal Resistant	IK07	N/A	IK08
Ingress Protection	IP54	IP65 (door station front only)	IP65
Construction	Stainless Steel	Matte Plastic	Aluminium
Installation Kit	Includes surface mount rain shield/bracket; flush mount optional	Includes surface mount bracket & Ethernet cable adapter	N/A
Power Input / Use	12VDC, Standby < 1W / Operation < 10W	12VDC, PoE (802.3af) / Standby < 1W / Operation < 10W	12VDC, PoE (802.3af) / Standby < 1W / Operation < 7W
Weight / Dimensions	0.80kg / 130 x 140 x 32mm	0.40kg / 135 x 70 x 34mm	0.80kg / 182 x 101 x 30mm
Diagrams			

## Standard Intercom Monitors | Series Specifications

Model	INTIPMONDB (Black) / INTIPMONDW (White)	
Product Image		
Main Processor	Embedded Microprocessor	
Audio / 2-Way Talk	Omni-directional Microphone & Embedded Loudspeaker for 2-way talk	
Display Size	7" Colour TFT (1024 x 600 pixels) with Capacitive Touchscreen & Soft Keys	
Alarm Support	6 Input / 1 Output	
Internal Capacity	MicroSD port max 32GB	
Ethernet / Network	10M/100Mbps Self-adaptive / TCP/IP protocol	
Installation	Included surface wall mounting kit & Ethernet cable adapter	
Operating Temperature	-10 ~ +55°C / 10 ~ 90%RH (max.)	
Power Input / Use	12VDC, PoE (802.3af) / Standby < 1W / Operation < 7W	
Weight / Dimensions	0.80kg / 215 x 140 x 21mm	
Product Diagram		

## Residential Series Example Installation | System Map

Easily install the VIP Vision IP Intercom System using the existing IP or WiFi network. The system can integrate IP cameras, up to 5 indoor intercom monitors and up to 20 door stations.

The system map below demonstrates a setup with 2 apartments, each of which are accessed from one 2 button door station. Apartment 2 has a secondary door station outside and an additional indoor monitor.

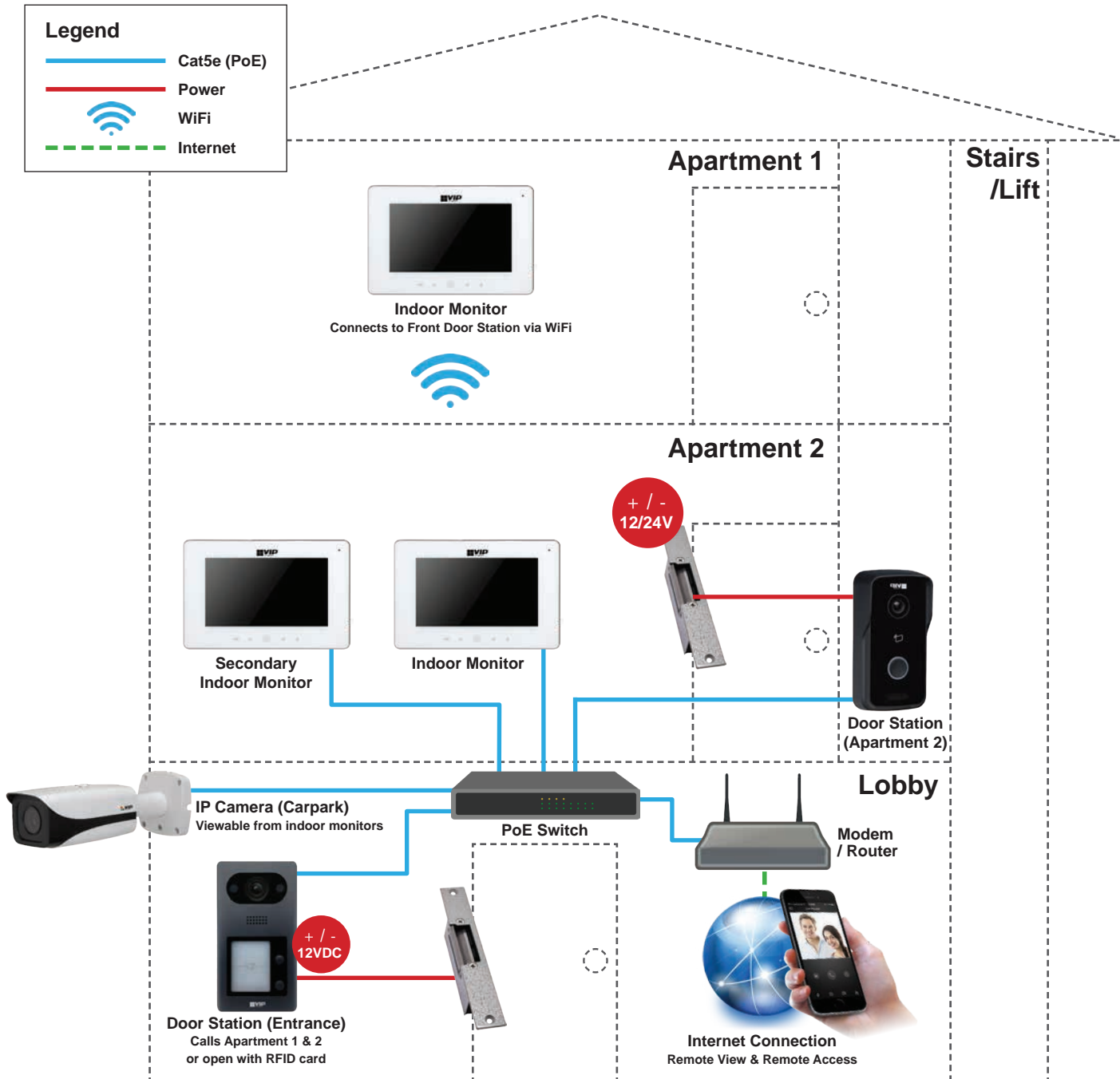

Your local VIP Vision™ Intercom solutions professional: